

Existing Soccer Pitch

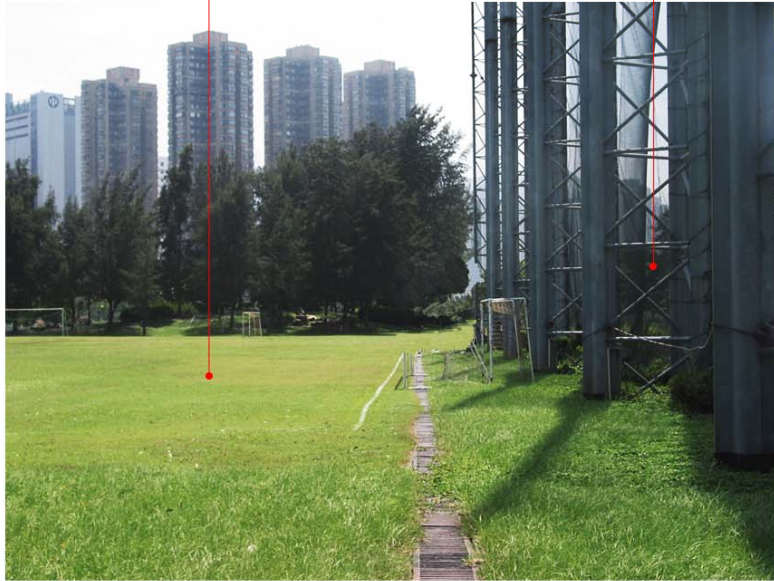

VIEW FROM EXISTING FOOTBALL FIELD

Existing Driving Range



Stable Precinct

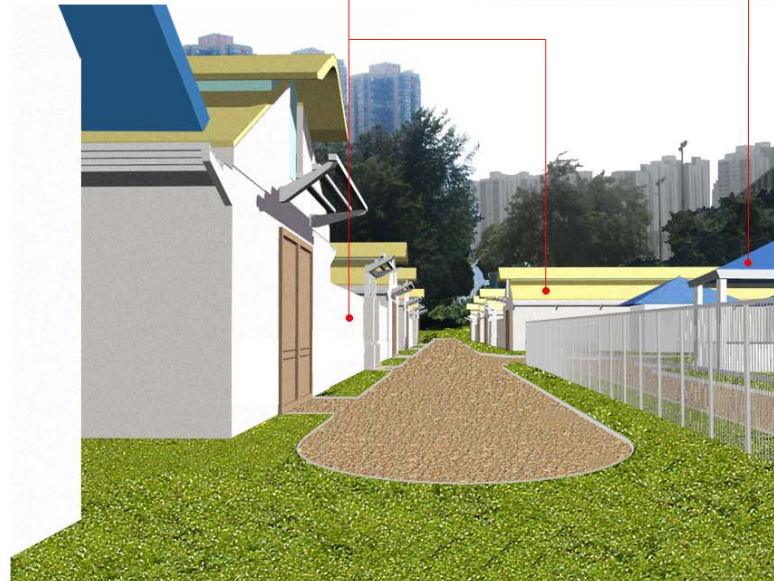

UNMITIGATED

Veterinary Farrier



MITIGATED



10 YEARS AFTER OLYMPIC EVENT

KEY PLAN



DISTRIBUTION CONTROL:
 THIS DRAWING REMAINS THE PROPERTY OF THE AUTHORING CONSULTANT EXCEPT AS PROVIDED IN THE CONDITIONS OF ISSUE. IT SHALL NOT BE COPIED OR REPRODUCED IN ANY FORM OR BY ANY MEANS, ELECTRONIC OR MECHANICAL, WITHOUT THE WRITTEN APPROVAL OF AUTHORING CONSULTANT.
 ALL DRAWINGS TO BE SUBMITTED TO ANY OTHER PARTY FOR COMMENT OR TO BE USED IN REFERENCE TO OBTAIN ANY DEVELOPMENT APPROVALS MUST BE MADE AND PLANS TO BE SENT TO THE RELEVANT OFFICE OF THE AUTHORITY.

REVISIONS		
REV. NO.	REVISION DESCRIPTION	DATE



香港賽馬會
 The Hong Kong Jockey Club

Lead Architects

TC & Co.

TIMOTHY COURT & COMPANY ARCHITECTS
 4th Floor, 110
 110, Austin Road, Kowloon, Hong Kong
 Tel: +852 2468 1822
 Fax: +852 2468 2301

Consulting Engineers
ARUP
 One Asia & Finance Hong Kong Ltd
 Level 2, Festival Walk, 80 Fort Chase Avenue
 Kowloon, Hong Kong
 Project@ARUP.COM
 Tel: +852 2228 0001
 Fax: +852 2268 4472

Documentation Architect
RLP
 Ronald L & Partners (HK) Ltd
 22nd Floor, Wu Chung House
 210 Queen's Road East
 Waihee, Hong Kong
 Tel: +852 2811 2218
 Fax: +852 2823 2274

Landscaping Architect
ACLA
 ACLA Limited
 127 Guangdong Investment Tower
 128 Cantonment Road, Central
 Hong Kong, Hong Kong
 Tel: +852 2893 9933
 Fax: +852 2892 2102

Quantity Surveyors
Levitt & Bailey
 Levitt & Bailey Quantity Surveyors Limited
 25th Floor, Queen's Central Plaza
 3 Yu Ming Road
 Midlevels, Hong Kong
 Tel: +852 2823 1822
 Fax: +852 2151 2344

PROJECT
2008 OLYMPIC EQUESTRIAN EVENT

PACKAGE
 SITE

TITLE
 PHOTOMONTAGE - VIEW FROM EXISTING FOOTBALL FIELD

DWG NO.
 ST/L/S/HK/543

PROJECT NO. SCALES
 NTS

PLOT DATE
 2 DEC 2005

CHECKED
 RAB

DRAWN BY
 PET

VERIFIED
 JSP